



**Also compatible with  
Dodge Ram TRX**

# User's Guide

For Firmware [18.2.4-041923](#)

The **Tazer DT** is an electronic plug-in device for the following vehicles:

**2018-2023** Ram 1500 DT

**2021-2023** Ram 1500 TRX

## Firmware Updates

New firmware is available periodically, always free and posted to the Z Automotive website. The Tazer may not ship with the latest firmware, so use [ZPU \(Z Automotive Programming Utility\)](#) for **Windows and MacOS** (ChromeOS not supported), also on the website, to install the firmware over USB.



**YOU DO NOT NEED TO UNMARRY TO  
UPDATE YOUR TAZER.**

## Contents

**CLICK or TAP to jump to section**

or

**Use CTRL + F (Windows) or ⌘ + F (MacOS) to search the document**

<b>Feature List</b>	<b>2</b>
• <a href="#">Vehicle Settings</a>	2
• <a href="#">Live Functions</a>	3
• <a href="#">Non-Menu Live Functions</a>	4
<b>Installation</b>	5
<b>CRITICAL INFORMATION</b>	6
<b>Menu Navigation</b>	7
<b>Returning to Stock (Unmarry)</b>	7
<b>Vehicle Settings</b>	7
• <a href="#">Submenu Performance</a>	8
• <a href="#">Submenu Tire</a>	8
• <a href="#">Submenu Radio</a>	8
• <a href="#">Submenu Lighting</a>	8
• <a href="#">Submenu Off-Road</a>	9
• <a href="#">Submenu Mirror</a>	9
• <a href="#">Submenu Other</a>	9
<b>Live Menu</b>	10
• <a href="#">Live Settings</a>	10
<b>Non-Menu Live Functions</b>	11
<b>Tazer Pin Lock Supplement</b>	13
<b>Updating Your Tazer</b>	15
<b>Custom Light Show Config</b>	15
<b>Unmarrying Your Tazer</b>	15
<b>The Unmarry Key</b>	15
<b>Troubleshooting</b>	16

# Feature List

**Tazer DT features can be broken into three categories:**

- **Vehicle Settings** are accessed with the **engine OFF** and the ignition in the **“RUN”** position. These are changes made to the truck such as tire size, gear ratios or settings which accommodate other upgrades. **These changes will continue to operate after the Tazer DT is unplugged.**
- **Live Functions** are accessed with the **engine ON**. These are operations the Tazer DT performs live, **only while it is physically connected.**
- **“Non-Menu” Live Functions** **are not located in a menu.** They are **activated automatically or with a steering wheel button combination.** These are operations the Tazer DT performs live, only while it is physically connected.

**NOTE: This is just a list of available features. To learn more about how to activate them or what they do, continue to the dedicated section of the manual for each set of features.**

## List of Vehicle Settings (ENGINE OFF, IGNITION IN “RUN”)

### Main Menu

- **“LightShow?”** 6 preset and 3 make-your-own light shows that flash all the exterior lights – perfect for car shows/first responders/off-road visibility – controlled from key fob or steering wheel buttons – can be enabled in-motion for use in parades, off-road and for legal police/EMS applications **(contact support for more info)**
  - **“Read/Clear DTCs?”** read and clear DTCs system-wide or in specific modules
- Submenus:**
- **“Perf?”** PERFORMANCE SUBMENU
  - **“TPMS?”** TPMS SUBMENU
  - **“Radio?”** RADIO SUBMENU
  - **“Lighting?”** LIGHTING SUBMENU
  - **“Off Road?”** OFF ROAD SUBMENU
  - **“Other?”** OTHER SUBMENU
  - **“Mirror?”** MIRROR SUBMENU
  - **“Marry?”** Marry to access the submenus, then one-touch **“Unmarry?”** Unmarry function returns to stock
  - **“TZDT: x.x.x.”** display firmware version
  - **“UnmryNo: xxxx”** display Unmarry Number **(ignore this unless instructed not to by support)**
  - **“Full Reboot”** reset vehicle modules and UConnect system.

## Performance Submenu

- **“Tire”** calibrate speedometer for non-factory tire sizes
- **“GrRatio”** calibrate speedometer for non-factory gear
- **“4 Low”** change the Transfer Case LOW ratio ratios

## Tire Submenu

- **“TPMS”** disable Tire Pressure Monitoring System warnings
- **“PSI Front/Back”** change the TPMS warning pressures

## Radio Submenu

- **“Cam En”** enable/disable the factory backup camera
- **“CargoCam”** enable aux video/audio for front camera and/or external video source **(8.4” and 12.1” UConnect only)**
- **“DVD\_CD”** enable/disable radio’s CD audio input
- **“TravelLnk”** enable/disable SiriusXM TravelLink

## Lighting Submenu

- **“DRLType”** choose full-time (Canada) or toggled (USA) DRLs
- **“DRL Loc”** set DRL location - choices:
  - DRL
  - Turns
  - Low beams
- **“DRL Drop”** disable Daytime Running Light Dropout (DRL shut-off while turn signal is on)
- **“Fogs En”** enable/disable factory fog lights
- **“Fog Drop”** enable/disable Fog Light Dropout (fog light shut-off while high beams are on)
- **“OneTouch”** enable/disable one-touch lane change
- **“LED CMHSL”** configure vehicle for LED Center Mounted High Stop Light
- **“Halo En”** enable/disable factory halos
- **“LED FOGS”** configure vehicle for LED fog lights
- **“LED Tails”** configure vehicle for LED tail lights  
**(aftermarket lights may require a resistor harness)**
- **“LED FTrn”** configure vehicle for LED front turn signals  
**(aftermarket lights may require a resistor harness)**
- **“TRLR Tow”** configure vehicle for the Trailer Tow package

## Off-Road Submenu

- **“EPSteer”** configure vehicle for hydraulic steering pump
- **“Locker”** delete factory axle lockers

## Mirror Submenu

- **“PwrFold”** enable/disable power folding mirrors
- **“MirTurn”** enable/disable mirror turn signals
- **“MirTow”** enable/disable tow mirrors
- **“MirApr”** enable/disable approach mirrors

## Other Submenu

- **“AUX”** enable/disable AUX button package
- **“BlindSpot”** enable/disable blind spot detection package
- **“PwrStep”** enable/disable MOPAR side-step
- **“TrlrBrk”** enable/disable MOPAR trailer brake controller
- **“BeltDing”** enable/disable seatbelt ding **(Experimental)**
- **“Splash”** change EVIC splash screen
- **“PanicBtn”** enable/disable keyfob Panic button

## List of Live Functions (ENGINE ON)

## LIVE Main Menu

- **“LightShow?”** activate Light Show
- **“PIN/Security?”** LIVE PIN Lock AND SECURITY SUBMENU
- **“Live Settings?”** LIVE SETTINGS SUBMENU
- **“TireFill?”** flash to indicate pressure while filling tires
- **“DarkMode?”** turn off exterior lights and dash/radio/shifter lights while parked with the engine running
- **“Video?”** cycle cameras/video inputs
- **“VAC”** display Vacuum Gauge
- **“ForceRWD”** force RWD or AWD **(not suitable for dyno use)**
- **“0-30/0-60 timer”** display 0-30 or 0-60 times on EVIC display

## LIVE PIN/Security Submenu

See the dedicated **“PIN Lock Supplement”** on page 13 to learn how to configure these advanced Tazer features.

## “LIVE Settings” Submenu

- **“BrakeHold”** automatically hold brakes at a red light
- **“InMoNav”** allow navigation entry in motion
- **“TurnCam”** activate rear camera while signalling **(5, 7, 8.4” UConnect)**
- **“Kill3Honk”** disable honks when leaving running vehicle wvith the keys **(driver door only for now)**

**Continued...**

- **“ParkCam”** activate surround and front cameras when ParkSense is triggered
- **“AutoFold”** automatically fold and unfold power mirrors with ignition
- **“AmberDRL”** override factory DRLs with amber
- **“AP Kill”** disable AutoPark system

- **“RemRestart”** automatically restart the vehicle once remote start times out after 15 minutes
- **“PlsBrkSpd”** and **“PlsBrkNum”** enable and customize third brake light flash pattern
- **“Winch XXXX”** define Winch Mode RPM

## List of “Non-Menu” Live Functions

(NOT IN A MENU – AUTOMATIC OR  
ACTIVATED WITH BUTTON INPUTS ONLY)

- activate Light Show (shortcuts)
- Drive Mode Memory - automatically remember drive mode on next restart
- Cooldown Mode – turn on engine fans on-demand with or without the engine running
- Winch Mode – raise idle RPM to user-selected value between 1250 and 2000
- Hood Alarm – monitor hood when alarm is armed to sound the alarm and flash a light show if opened
- Line Lock – use ABS solenoids to lock the front wheels for burnouts at the track or just for fun (**AWD forced off during use**)
- Rock Crawl – lock all four brakes with a steering wheel button combo to hold the vehicle still, especially helpful when off-road
- TC Kill – turn off traction control, stability control and ABS
- use backup camera and added cargo/front camera or media player at any speed with a button shortcut
- Turn Assist – lock the inside back tire for sharper turns (button remap function only)
- Remote Start Extend - remote start back to back an unlimited number of times (stock function only allows twice) if RemRestart is enabled
- Windows from Keyfob - open and close windows with a keyfob shortcut
- remap cruise +/-/RES buttons to:
  - Any of the 9 light shows
  - rear camera
  - TC Kill
  - Line Lock
  - Rock Crawl
  - Winch Mode
  - Cooldown Mode
  - Force RWD
  - Turn Assist
- Partial Reboot

**NOTE: This was just a list of available features. To learn more about how to activate them or what they do, continue to the dedicated section of the manual for each set of features.**



# Installation

- Reach under the driver side kick panel towards the left side and look straight up to find the security gateway plugs.
- Press the tabs on the sides of the two plugs and pull down by the wires and insert the plugs into the Tazer DT.
- Plugs may not seat all the way to the base, but they should seat securely. We allow some clearance to make it easier to disconnect the Tazer DT.
- The Tazer DT LED should blink when the vehicle is running, indicating power. If it does not, contact support.

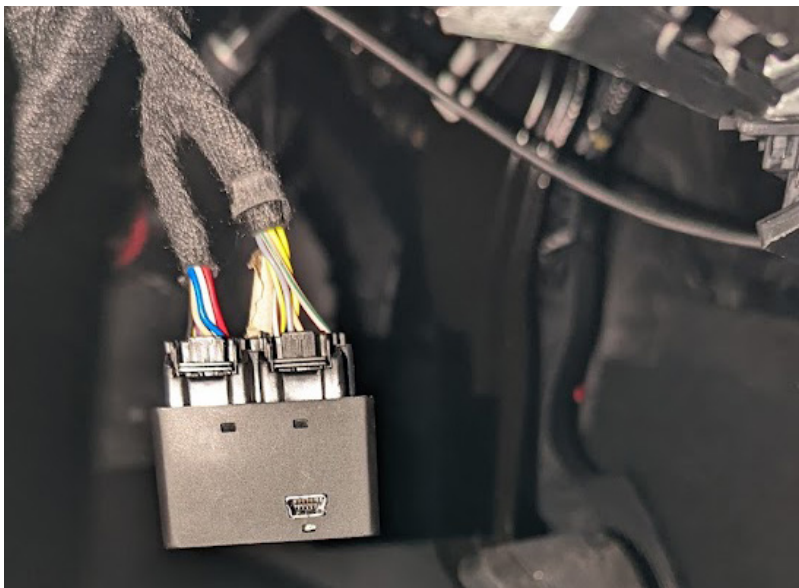
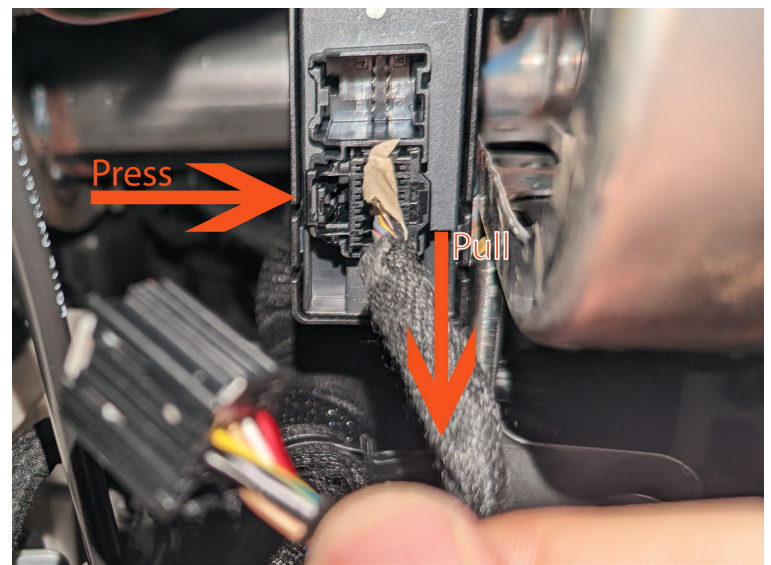
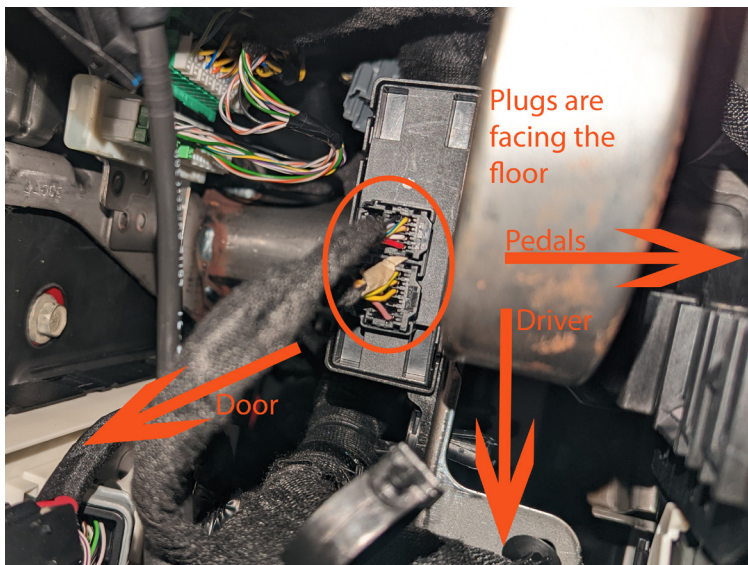
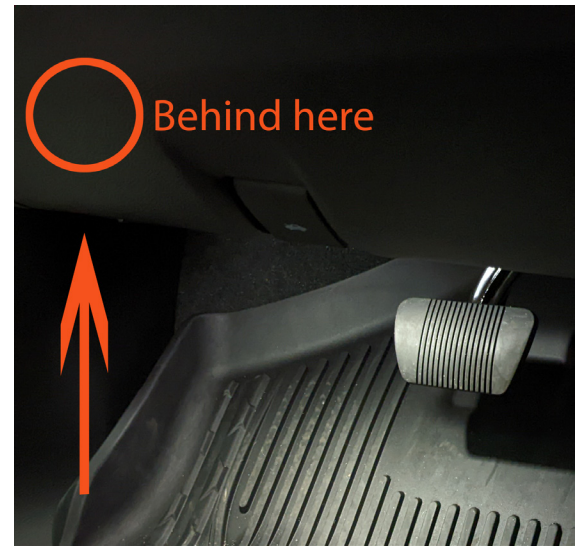

**NOTE:** An optional **SGW Extension Cable** is available from our website for easier removal.

# CRITICAL



**AUTOMOTIVE**  
Electronic Performance Modifications

6

**Read everything on this page CLOSELY.**

**EVERY SINGLE TIME** YOU MAKE CHANGES IN THE “VEHICLE SETTINGS” (ENGINE OFF) MENU **OR UNMARRY, YOU MUST PERFORM A FULL REBOOT AND TWO SLEEP CYCLES.** THIS PROCESS IS EXPLAINED HERE:

## How to perform a FULL REBOOT AND TWO SLEEP CYCLES

- After making all of your changes, scroll to “full reboot?” and select it.
- Wait for the countdown, then perform two sleep cycles.
- The quickest way to do two sleep cycles is to turn the ignition off, open and close the driver’s door and wait about 60 seconds AFTER the dash goes dark, then turn the ignition on (but not the engine) and repeat once more.
- **This step is critical after changing settings** or settings might not save, or you may find that the dash doesn’t shut down, which can result in a dead battery.

**Full Reboots should be performed on level ground, with the wheels straight and with your foot off the brakes.**

## Returning to Stock (Unmarry)

**SELECT “UNMARRY?” FROM THE VEHICLE SETTINGS MENU AND PERFORM THE STEPS ABOVE TO RETURN YOUR VEHICLE TO STOCK CONFIGURATION\***

\*Your Tazer stores the configuration present when it’s Married. That will be what it returns to when you Unmarry, even if it wasn’t stock.

**You should Unmarry and remove your Tazer before dealer service or if you wish to use your Tazer in another vehicle.**



# Menu Navigation

- For all functions involving the dash (EVIC) display, the EVIC screen first needs to be in a state where it's showing the **AUDIO screen**. Navigate to this screen using the steering wheel arrow buttons.
- Once the display is in this state, use the button commands below to operate your Tazer DT.

Function	Button Input
OPEN MENU/SCROLL MENU	◀ (HOLD) + <b>CRUISE CANC</b>
SELECT/CHANGE OPTION or SAVE VALUE (TIRE SIZE, TPMS THRESHOLD, ETC.)	◀ (HOLD) + <b>CRUISE ON/OFF</b>
ADJUST VALUE (TIRE SIZE, TPMS THRESHOLD, ETC.)	◀ (HOLD) + <b>CRUISE +/-</b>

## Vehicle Settings

This section explains the Vehicle Settings, used primarily for feature activation.

The **Vehicle Settings** menu is accessed with the ignition in **“Run”** (not **“ACC”**) and the engine **NOT** running.

**The menu items are listed in the order in which they will display.**

### Main Menu

- Light Shows “LightShow?”:** Activate pre-programmed and custom light shows, even when the engine isn't running.
- Read DTCs:** View any error codes in the
  - Powertrain Control Module (PCM)
  - Body Control Module (BCM)
  - Transmission Control Module (TCM)
  - Anti-lock Brake System (ABS)
  - Drivetrain Control Module (DTCM)
  - Radio Frequency Hub (RFH)
  - Drive Assistance Module (DASM)
  - Occupant Restraint Controller (ORC)
  - ParkTronic System (PTS)
  - OBD Readiness Monitor (Readiness)
- Clear DTCs:** Clear any error codes in those same systems
- “Marry”:** To advance to any of the vehicle settings, you will first need to **“Marry” the Tazer to the vehicle**. When you select this option, the Tazer will download your car's **current** (presumably stock) settings. This should take around 15 seconds. **Do not disturb this process. This option will change to “Unmarry” once Married. See the previous page for details.**
- Submenus:** Once married, you can advance through several sub-menus. Select a submenu using the method described above. Submenus and their contents are listed starting on the next page.
  - “Perf?”** PERFORMANCE SUBMENU
  - “Tire?”** TIRE SUBMENU
  - “Radio?”** RADIO SUBMENU
  - “Light?”** LIGHTING SUBMENU
  - “Offroad?”** OFFROAD SUBMENU
  - “Other?”** OTHER SUBMENU
- Firmware Version Display “TZDT: x.x.x.”:** Shows the current Tazer firmware revision.
- Unmarry Number “UnmryNo: XXXX”:** Shows the current “Unmarry Number” ([see page 13](#)).
- Full Reboot “FullReboot?”:** This option resets vehicle modules and the UConnect system twice. The dash will reset. When finished, the red dash security dot will turn on. It may turn off or not depending on the vehicle. This takes 2.5 minutes and **should be performed after any Vehicle Settings are changed**. Follow with two sleep cycles as described on the previous page.



## Perf Submenu “Perf”: tire and performance-based options

- **Set Tire Size “Tire”**: This setting will change the programmed tire diameter. Use the hand-measured height in inches for accurate sensor readings.
- **Set Gear Ratio “GrRatio”**: This setting will change the programmed gear ratio to match new gears
- **Set Transfer Case LOW Ratio “4 Low”**:  
This setting will change the programmed 4Lo gear ratio.

**NOTE:** Use **◀/BACK(HOLD) + CRUISE+/-** to raise or lower these values and **◀/BACK(HOLD) + CRUISE On/Off** to save the setting.

**NOTE:** For these settings, after the required **Full Reboot and two sleep cycles**, go for a **20 minute drive**, preferably highway, so that all sensors adjust. **This process will assure that the speedometer and shift points recalibrate.**

## Tire Submenu “Tire”: TPMS options

- **Set TPMS “TPMS”**: Change the tire pressure monitoring system type – good when using drag radials or winter tires when the sensors aren’t present anyway. Can be NONE (disabled), BASE (low tire warning only), or PREMIUM (individual tire pressure).
- **Set Tire Pressures Front/Rear “PSI Front/Back”**: This setting changes the TPMS warning pressures – use **◀/BACK(HOLD) + CRUISE+/-** to raise

or lower the pressure and

**◀/BACK(HOLD) + CRUISE On/Off** to save the new setting. **The truck’s computer will only recognize a minimum of 25 PSI.**

**NOTE:** For these settings, after the required **Full Reboot and two sleep cycles**, go for a **20 minute drive**, preferably highway, so that all sensors adjust. **This process will assure that the TPMS sensors recalibrate.**

## Radio Submenu “Radio”: radio-based options

- **Set Backup Camera “Cam En”**: This setting enables a **newly-added** factory backup camera.
- **Set Cargo Cam “CargoCam”**: This setting will add the Cargo Cam selector to the camera view and activate the input for use with a Z Automotive front camera, AV kit, **OR** HDMI-AV Kit. **You may only use one.**

- **Set DVD/CD “DVD\_CD”<sup>1</sup>**: This setting activates the CD input on the radio, for use as an aux input, particularly for the Z Automotive AV or HDMI-AV Kit.
- **Set Travel Link “TravelLnk”**: This setting adds the ability to disable SiriusXM Travel Link, which turns off the weather pop-ups. Also disables SiriusXM Traffic information.

## Lighting Submenu “Lighting”: DRL and other lighting options

- **Set DRL Type “DRLType”**: Choose USA (on but selectable), Canada (on all the time) or OFF (disabled).
- **Set DRL Location “DRL Loc”**: Choose which lights to use as DRLs (results vary with vehicle model) - choices:
  - DRL
  - Turns
  - Low beams
- **Set DRL Dropout “DRL Drop”**: Set to OFF, this will keep the DRLs on even when a turn signal is in use.

- **Set Fog Lights Enable “Fogs En”**: This setting enables newly-added factory fog lights.
- **Set Fog Dropout “Fog Drop”**: Set to OFF, this will keep the fogs on even when the high beams are in use.
- **One-touch “OneTouch”** enable/disable one-touch lane change
- **Set Halo Enable “Halo En”** enable/disable factory halos



- **Set LED Third Brake Light “LED CMHSL”** configure vehicle for the LED third brake light
- **Set LED Fogs “LED FOGS”** configure vehicle for LED fog lights
- **Set LED Tails “LED Tails”** configure vehicle for LED tail lights (aftermarket lights may require a resistor harness)
- **Taillight Type “Tail”** configure taillights for overseas conversion (If you are unable to restore the default value, you should Unmarry as described on page 6 to return to stock.)

## Offroad Submenu “Offroad”: offroad-related options

- **Set EPSteer “EPSteer”**: This setting is used if you deleted the factory electronic steering pump for a hydraulic pump.

## Mirror Submenu “Mirror”: mirror options

- **Set Power Mirrors “PwrFold”**: This setting activates newly-added MOPAR power folding mirrors.
- **Set Mirror Turns “MirTurn”**: This setting activates newly-added side-mirror turn signals.

## Other Submenu “Other”: additional vehicle settings

- **Set AUX “AUX”**: Set to YES, this configures the vehicle for the AUX button package.
- **Set Blind Spot “BlindSpot”**: Set to YES, this configures the vehicle for the AUX button package.
- **Side Step “PwrStep”**: This setting will activate the MOPAR side step (Mopar Deployable Step Kit 82215287AD) after installation.
- **Trailer Brake “TrlrBrk”**: This setting will activate a MOPAR trailer brake controller.
- **Set Seatbelt Ding “BeltDing”<sup>1</sup>**: Set to OFF, this will disable the chime when your seatbelt is off. The seat belt warnings on the dash will continue to function. (EXPERIMENTAL) Always wear your seatbelt.

- **Set LED Front Turn “LED FTn”** configure vehicle for LED front turn signals  
**NOTE:** For this setting, after the required **Full Reboot and two sleep cycles**, run each blinker for **20 seconds each**. If this does not clear hyperflash and you have **aftermarket lights**, your lights **might require a resistor harness**.
- **Set Trailer Tow “TRLR Tow”**: Configure the vehicle for MOPAR trailer towing wiring kit

- **Set LOCKER “Locker”**: This setting is used if you deleted the factory axle lockers. You can delete front only, or both.

- **Set Mirror Tow “MirTow”**: This setting activates newly-added mirror lights.
- **Set Mirror Approach “MirApr”**: This setting activates newly-added approach mirror lights.

- **Set Splash “Splash”**: With this setting you can choose the cluster splash screen. **There are many choices but not all will work, and some may set an error. TRX can only use the TRX splash.**
- **Set Panic “PanicBtn”**: Set to NO, this disables the PANIC button on the keyfob.
- **SGW Lock “sgw”**: Set to NO, this allows access through the security gateway for dealer tools. **Use this feature only if you know your dealer doesn't mind aftermarket mods. Otherwise, you should Unmarry and remove the Tazer before dealer service.**

# Live Menu Settings

This section explains the Tazer's Live Settings – these are activated with the same button presses as the Vehicle Setting, but **while the engine is RUNNING\***. These features **will only work if the Tazer remains plugged in.**

## Main Menu

- **Light Show “LightShow?”**: This is one method of activating the light shows. Selecting this will activate the first show, unless ZPU was used to change the startup show. There are 9 light shows – you can toggle through all 9, then back to OFF.
- **Security Settings “Security/PIN?”**: Select this to enter the Security Settings submenu which includes [the features outlined on page 13.](#)
- **Live Settings “LiveSettings?”**: Select this to enter the Live Settings submenu which includes the adjustable options listed in the next section.
- **TireFill “TireFill?”**: Set the PSI with **◀/BACK(HOLD)** + **CRUISE +/-** and the marker lights near each tire will
  - flash slowly if underfilled
  - flash quickly if overfilled
  - remain solid at the correct pressure
- **Dark Mode “DarkMode?”**: Set to ON, this will turn off vehicle lights. **Advance to the next menu item, press “Screen Off,” or drive over 5 mph to cancel this mode.**
- **Set Video “Video?”<sup>1</sup>**: Select to cycle between camera and video inputs.
- **Force RWD “ForceRWD?”**: Select Normal, Force RWD or Force AWD. You can change the setting at any time, but the change will only occur when the car is not in motion. **This feature is not suitable for dyno use.**
- **0-30 Timer “0-30”**: Select this option with the vehicle stopped and the display will change to “start 30.” As soon as the vehicle starts moving, the display will change to “go to 30” and the timer will start. When the vehicle reaches 30MPH, the time will be displayed.
- **0-60 Timer “0-60”**: Select this option with the vehicle stopped and the display will change to “start 60.” As soon as the vehicle starts moving, the display will change to “go to 60” and the timer will start. When the vehicle reaches 60MPH, the time will be displayed.
- **Display Tazer Firmware Revision**: Displays the Tazer's current firmware version: “TZDT: x.x.x.” (ie “TZDT: 18.1.X”)

## Security/PIN Settings Submenu: adjustable security options

**See the dedicated “PIN Lock Supplement” on page 13 to learn how to configure these advanced Tazer features.**

## Live Settings Submenu: adjustable LIVE options

**NOTE:** When using TurnCam or the Mute shortcut, **avoid turning the camera off using the on-screen “X.”** Instead, wait for the TurnCam to turn off after your signal or use the Mute shortcut again to turn the camera off.

- **Brake Hold “BrakeHold”**: Set to ON, this will automatically hold your brakes after **pressing the brake firmly for 2 seconds under these circumstances:**
  - not in a Tazer dashboard menu
  - at a full stop
  - your seatbelt is on
  - in drive
- **Set In-Motion Nav “InMoNav”**: Set to ON, this allows address entry while the vehicle is in motion. **This is for PASSENGER use.** It may be illegal for the driver to manipulate the navigation system while driving. **It is recommended to leave this setting OFF,** enabling it only when you need to use it. **This will automatically be disabled if TurnCAM is enabled.**
- **“TurnCam”**: Set to yes, this will automatically turn on the backup camera if the turn signals are being used. **This will automatically be disabled if In-Motion Nav is enabled.**

- **“Kill3Honk”**: Set to yes, this will disable the honks that sound when leaving the running vehicle with the keys (**driver door only for now**)
- **“ParkCAM”**: Set to yes, this will automatically turn on SurroundView and the front camera when front ParkSense is triggered.
- **“AutoFold”**: Set to ON, this will automatically retract and extend the power folding mirrors (if equipped) with ignition.
- **“AmberDRL”**: This setting will override factory DRLs with amber DRLs and marker/hood lights. Options include:  
**Day** (on with headlights off)  
**Night** (on with headlights on)  
**Both** (on full-time)
- **AutoPark Kill “AP Kill”**: Set to yes, this will automatically disable the AutoPark feature when the

vehicle is turned on and foot is on the brake. For safety, this will be disabled past 30mph and will reenable when the vehicle is put in Park.



- **“RemRestart”**: Set to ON, this will automatically restart the vehicle once remote start times out after 15 minutes.
- **Pulse Brake Speed “PlsBrkSpd”**: Choose an option to enable and set the third brake light pulse speed.
- **Pulse Brake Number “PlsBrkNum”**: Set the number of brake light flashes.
- **Winch RPM “Winch XXXX”**: Select this option with **</BACK(HOLD) + CRUISE ON/OFF** then use **</BACK(HOLD) + CRUISE +/-** to adjust the Winch Mode RPMs between 1300 and 2000. Use **</BACK(HOLD) + CRUISE ON/OFF** to save the setting.

## Non-Menu Live Functions

Some **live** functions of the Tazer DT are **not accessed via a menu**, but rather work automatically or with **button presses**.

- **Light Show Shortcuts**: The Tazer DT has two button shortcuts to start Light Shows. Those are:  
**Keyfob**: Press **UNLOCK, UNLOCK, LOCK, UNLOCK** on the keyfob to start the first light show in the sequence (depending on which show it's configured to start with). Pressing unlock again will advance to the next enabled show. **Pressing lock will turn off the light shows**. You may lock the vehicle while the shows are on by pressing the button on the door handle or using the key.  
**Adaptive Cruise buttons**: See the button remap instructions below. Press the remapped button to turn the Light Show on or off.  
**The light show will shut off if it's used for such a long time that the vehicle battery voltage drops below 11V.**
- **Cooldown Mode**: Press **> + CRUISE CANCEL** to turn the engine fans on High. **Press again to turn them off.**  
**NOTE**: When the engine is off, the fans will turn off automatically if the battery drops to 11V.  
**NOTE**: The transmission temperature will read as 229F while this mode is being used with the engine running.  
**NOTE**: Only works with the engine OFF on manual trucks
- **Winch Mode**: Press **</BACK(HOLD) + CRUISE RES** to raise the idle RPMs to the value selected in the live menu (default 2000). There may be a few-second delay before it changes. Touching the accelerator will cancel Winch Mode.
- **Line Lock**: While in **2WD** and at a full stop, press **</BACK(HOLD) + CRUISE+** buttons. Once the ABS and Brake lights on the dash begin to flash, continue to hold the buttons and pump the brake pedal twice firmly and release. The truck will stay held using only the front brakes while you press on the accelerator to do a burnout. “LineLock” will be displayed in the cluster.

**Continued...**

- **Rock Crawl:** This feature holds all four brakes while you work the pedals to apply torque. Press and hold  **BACK(HOLD) + CRUISE-** and pump the brakes twice. Once “RockCrawl” shows on the EVIC, release the buttons when you’re ready to start moving.
- **Full traction control disable:** **PRESS AND HOLD THE TRACTION BUTTON FOR 5 SECONDS** to fully disable TC and ABS. Shut off and restart the vehicle to reenable.
- **Set Camera:** Rather than using the menu to cycle cameras and video inputs, they can also be cycled by **quickly tapping the radio MUTE button twice.**
- **Turn Assist (button remap ONLY):** **TURN THE WHEEL, THEN PRESS THE REMAPPED BUTTON** to lock the inside back tire for sharper turns.
- **Windows from Keyfob:** **TAP Lock six times quickly** to roll the windows up or down. **The doors must be closed and the engine must be running.**
- **Button Remap:** **HOLD Right Arrow () and TAP** the desired button to map a hotkey function to it. **You can use the Cruise +, -, and RES buttons.** Simply **TAP the remapped button alone** to use the function. The choices are:
  - **Any of the 9 light shows**
  - **rear camera**
  - **TC Kil**
  - **Line Lock**
  - **Rock Crawl**
  - **Winch Mode**
  - **Cooldown Mode**
  - **Force RWD**
  - **Turn Assist**

Keep in mind that not all functions pertain to all vehicles.



These supplemental instructions apply to all vehicles equipped with:



Firmware [2.5.9-041823 or newer](#)

Firmware [11.4.5-041923 or newer](#)

Firmware [18.2.3-041723 or newer](#)

# PIN Lock Menu Supplement

**The Tazer PIN Lock** allows you to set a steering wheel button sequence (PIN) that must be entered before the vehicle can be driven and provides for the vehicle to become immobilized in the event of an attempted theft through triggering the PIN Lock, key pairing or triggering the factory alarm. This is the most complex feature of the Tazer and provides a high level of security against vehicle theft. **This PIN will need to be entered when the vehicle is started or after you exit the running vehicle with your key.**

## List of Menu Options (in order):

“**Set PIN**” set the desired button sequence (PIN). Changes to “Clear PIN” once set

“**Clear PIN**” erase the PIN. Changes to “Set PIN” once selected

“**Enable/Disable PIN**” quickly disable or enable the PIN Lock feature without erasing the PIN. This enabled by default

“**KillPedalNow**” a “high-security parking mode” which will disable the gas pedal until the next time the PIN is entered

“**PIN Brakes**” toggle whether triggering the PIN Lock will lock all four brakes when the vehicle is stopped.

“**PIN Horn**” toggle whether triggering the PIN Lock will cause the horn to honk in a randomized pattern.

“**PIN Lights**” toggle whether triggering the PIN Lock will start a Light Show.

“**PIN Pedal**” toggle whether triggering the PIN Lock or vehicle alarm, or an attempt to pair a key, will disable the gas pedal. This will function regardless of PIN enable/disable.

“**KillByFob**” toggle whether locking the vehicle from the fob will disable the gas pedal.

“**Carjack**” toggle Carjack Mode, which triggers when the key exits a running vehicle. This requires that a PIN is set and that PIN is enabled.

“**PIN Clear Time**” set whether it should take 10 or 60 minutes to clear a forgotten PIN using the process described below. This is set to 10 minutes by default.

## SPECIAL NOTE: The PIN Lock Bypass

- You will not be prompted to enter your PIN when PedalKill is enabled and the vehicle is unlocked from fob.
- You will not be prompted to enter your PIN when the vehicle has been turned off but has not gone to sleep yet before being started again.

**NOTE:** If utilizing PIN Pedal, the vehicle may stumble or stall after entering your pin while the pedal is reenabled.

**NOTE:** See the “Customizing PIN Lock” section below for more details about the toggleable measures.

**NOTE:** The EVIC screen must be set to Audio for text related to the PIN Lock feature to display on the screen. PIN Lock will still operate as described otherwise.

**NOTE:** 2011 vehicles will see “Keyfob Battery Low” instead of “Keyfob Not Detected” during dashboard reminders.

**NOTE:** In any instance that the vehicle is immobilized by the Pin Lock feature, in the Wrangler 4XE, the motor will shut off and the vehicle will become stuck in Park instead of locking all four brakes.

## Setting your PIN:

1. Select the “Set PIN?” option in the **PIN Lock** menu with **◀/BACK(HOLD) + CRUISE On/Off** to begin the process.
2. Enter a **one to six button sequence** that will allow the operator to drive the vehicle. The symbols in parentheses will appear on the screen to indicate the respective buttons.

### Your button choices are:

- **Cruise + (+)**
- **Cruise - (-)**
- **Cruise Cancel (<)**
- **Cruise RES (>)**

and if you have Adaptive Cruise Control

- **Near ACC (N)**
- **Far ACC (F)**
- **ACC Enable (A)**

**Hitting a seventh button will abort the process** and allow you to start over.

3. **Save your PIN with CRUISE On/Off.** “Pin Saved” will display.

**After turning the vehicle off, this PIN will now be required to drive the vehicle** and “Set PIN?” will change to “Clear PIN.”

## Removing the PIN:

1. Start your vehicle and enter your PIN.
2. Navigate to the PIN Lock menu and select “**Clear PIN.**”  
**After turning the vehicle off, the PIN will no longer be required to drive the vehicle** and “Clear PIN?” will change to “Set PIN.”

## If you forget your PIN:

**To remove the PIN Lock after the PIN Lock is triggered:**

1. Select “**Clear PIN**” from the PIN Lock menu. The dash screen will read “**Brake+Hazard.**”
2. Turn on your hazard lights and apply the foot brake. By default, this will trigger a 10-minute countdown.
3. **Keep the vehicle running and your foot on the brake until this countdown is finished and the PIN Lock will be removed.**

**Starting your vehicle with the PIN Lock active:**

1. A 40-second countdown will begin, displayed on the cluster.
2. The dashboard turn signal indicators will flash and blink
3. At 10 seconds, a “Keyfob Not Detected” warning will display on the cluster, accompanied by an audible chime, as a final reminder to enter your PIN.
4. If PIN Pedal is enabled, at 5 seconds, the gas pedal will be disabled.
5. At 0 seconds, the PIN Lock will trigger.

**Entering your PIN:**

1. Enter your pin before the countdown ends and before shifting out of Park to disarm PIN Lock and begin operating the vehicle.
2. Enter your pin while the PIN Lock is already triggered to disarm the PIN Lock and begin operating the vehicle.
3. If you make a mistake, pause for two full seconds or press **CRUISE On/Off** to start over.

The symbols described previously will appear on the cluster to indicate the buttons you’ve pressed. Once the correct PIN is entered, the cluster will display **“PIN Unlocked.”**

**What happens when PIN Lock is triggered?:****If PIN Brakes, Horn, Lights and Pedal are enabled:**

1. A Light Show will begin.
2. The horn will honk in a random pattern.
3. All four brakes will lock up.
4. The gas pedal will be disabled.

**These individual measures can be enabled or disabled using their respective PIN Lock Menu options.**

**What triggers the PIN Lock?:**

1. failure to enter your PIN before the PIN countdown ends
2. shifting out of Park before the PIN countdown ends (from vehicle start)
3. whenever the vehicle is stops with a carjacking in progress (from Carjack Mode, see below)

**Carjack Mode:**

**With a PIN set and enabled, when the vehicle is running and you leave the vehicle with the key and close the door,** Carjack Mode will be initiated.

1. Once the vehicle starts moving again, a 20-second PIN countdown will begin.
2. At 10 seconds, a “Keyfob Not Detected” warning will display on the cluster, accompanied by an audible chime, as a final reminder to enter your PIN.

3. At 5 seconds, the gas pedal will be disabled.
4. Once the vehicle comes to a stop, PIN Lock is triggered.
5. Enter the PIN at any point during this process to unlock the vehicle and return to normal operation.

**Note:** If enabled alongside PIN Lock, there will be an audible chime and “Keyfob not Detected” message on the dash every time the driver door is opened as a reminder that Carjack mode will be initiated if you exit the running vehicle with the key.

**Customizing PIN Lock:**

**The following menu options can be used to change the behavior of PIN Lock:**

- **“PIN Brakes”** toggle whether triggering the PIN Lock will lock all four brake when the vehicle is stopped. This is disabled by default.
- **“PIN Horn”** toggle whether triggering the PIN Lock will cause the horn to honk in a randomized pattern. This is disabled by default.
- **“PIN Lights”** toggle whether triggering the PIN Lock will start a Light Show. This is disabled by default.
- **“PIN Pedal”** toggle whether triggering the PIN Lock or vehicle alarm, or an attempt to pair a key, will disable the gas pedal. This is disabled by default.  
**Note:** This setting will remain in effect even if PIN Enable has been turned off. The pedal will also be disabled if the vehicle alarm is triggered or a key pairing is attempted.  
**Note:** While the pedal is disabled, several warning chimes and lights will trigger as if there are vehicle errors. If the pedal is reenabled while the vehicle is running, the engine may stumble or stall.
- **“KillByFob”** toggle whether locking the vehicle from the fob will disable the gas pedal. This is enabled by default.  
**Note:** The exterior lights will flash two additional times to confirm the pedal has been disabled/enabled. Unlocking using the same fob will reenable the pedal.  
**Note:** This setting will remain in effect even if the PIN function has been turned off.  
**Note:** If the vehicle is unlocked with the key or proximity entry using a different fob, the PIN will need to be entered even if the PIN Lock has been turned off with the “Enable/Disable PIN” option.
- **“Carjack”** toggle Carjack Mode, which triggers when the key exits a running vehicle. The is disabled by default and requires that a PIN is set and that PIN is enabled.
- **“PIN Clear Time”** set whether it should take 10 or 60 minutes to clear a forgotten PIN using the process described above. This is set to 10 minutes by default.

# UPDATING/LIGHT SHOW CONFIGURATION

Updating your Tazer firmware is done with the [Z Automotive Programming Utility](#), which **requires a computer or other device running Windows or MacOS Catalina or newer** and an available USB port. The ZPU User Guide at the link above explains how to install ZPU and how to perform firmware updates. **If you misplace or damage your USB cable, you can replace it with any common “USB Mini B” data/charging cable.**

Please see the accompanying “[Light Show Configuration Guide](#)” to configure your Tazer DT’s light show options in ZPU

## UNMARRYING YOUR TAZER

**To Unmarry your Tazer**, select “Unmarry” from the Vehicle Settings Menu (not Live). Then perform a “Full Reboot” and two sleep cycles as described on [page 6](#). **All of your settings will revert to whatever they were when you originally Married your Tazer.**

**You should Unmarry and remove your Tazer before dealer service or if you wish to use your Tazer in another vehicle.**

## The Unmarry Key

**NOTE:** This feature is **only** for when your Tazer is Married to **another vehicle**.

If you receive a Tazer second-hand, or lose access to your vehicle without unmarrying your Tazer and receive the “**Not VIN XXXX**” error:

1. Navigate to the “UnmryNo” item in the Tazer’s EVIC menu, described on [page 7](#).
2. Write this key down, and visit this URL to purchase our Unmarry Service, where you’ll be prompted to enter that key: <https://www.zautomotive.com/product/unmarry-key/>
3. Return to the UM Key option in the EVIC menu and hit (Left Arrow + Cruise+/-) to begin entering the code provided with your purchase.
4. Press Left + Cruise On/Off to proceed to the next character.
5. Once you’ve entered the last (eighth) digit, your Tazer will report whether the unmarry has succeeded or failed.

# Common Troubleshooting Questions

Symptom	Cause	Solution
No menu in EVIC	EVIC display has to be in a state where it can display radio station name	Set EVIC so it's showing radio station name. This would be the the "Audio" menu on the instrument cluster
Changed a setting and it didn't take effect	Full Reboot and 2 sleep cycles were not performed	Follow the directions on <a href="#">page 5</a> .
Changed gear ratio and "service AWD" is showing	Incorrect gear ratio chosen or Full Reboot and 2 sleep cycles were not performed	Follow the directions on <a href="#">page 5</a> and go for a short drive to fully initialize.
Brake light flashes or the brake pedal sinks	Brake Hold is enabled and operating or PIN Lock is triggered	Read about Brake Hold on <a href="#">page 10</a> and PIN Lock on <a href="#">page 13</a> .
Accelerator pedal is disabled, dash displays a lightning bolt and other errors.	PIN Lock is triggered.	Enter your PIN or reenable the pedal with KillPedalNow. See <a href="#">page 13</a> .

Z Automotive cannot be held responsible misuse or consequential damages.

If you are in doubt, email [support@zautotech.com](mailto:support@zautotech.com).

Please be aware that modifying your vehicle in any way can affect your vehicle's warranty, longevity, handling, etc.

Please use with caution, and AT YOUR OWN RISK.

USING THE LIGHT SHOW FEATURE ON PUBLIC ROADS: IMPERSONATING A POLICE OFFICER IS A FELONY. LIGHT SHOW IS INTENDED FOR CAR SHOW/TRACK/OFF ROAD USE ONLY.

Z Automotive is in no way affiliated with FCA.

Protected by US Patents  
10,885,039; 10,759,328; 10,431,946; 10,266,102; 9,937,850; 9,849,826;  
and other patents pending.